

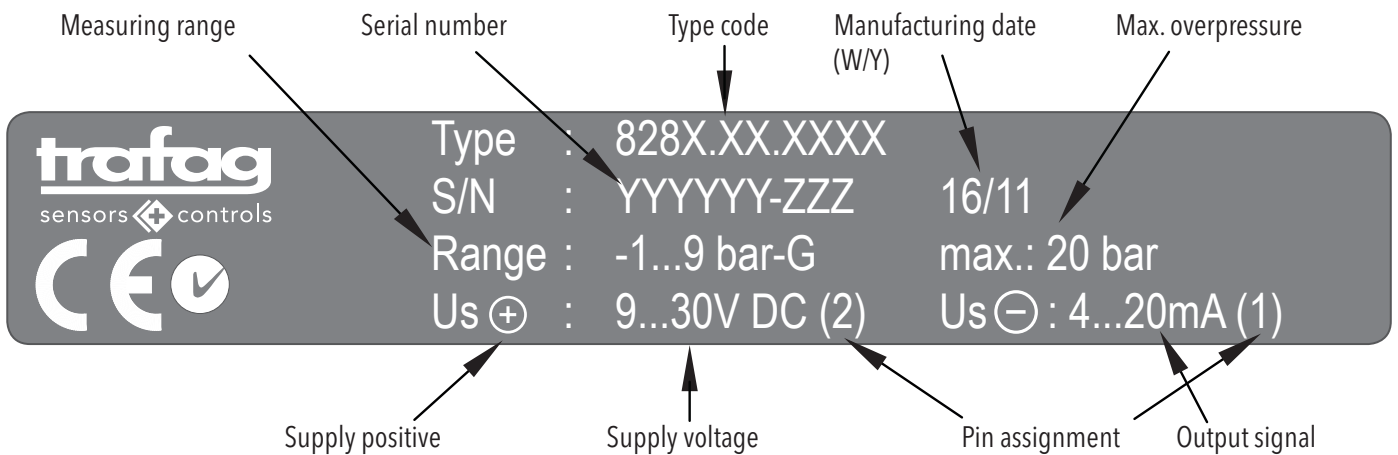

Technical specification

Mounting torque: 25 Nm
 Ambient temperature: -40°C ... +125°C
 Cable PVC: -5°C ... +60°C / Cable PUR: -20°C ... +70°C / Cable Raychem: -20°C ... +100°C
 Media temperature: -40°C ... +125°C,
 -25°C ... +125°C, -18°C ... +125°C, depending on seal material

Type label description

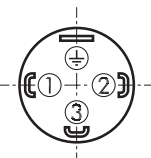
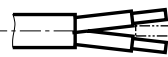
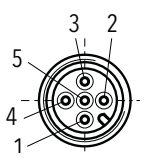

Electrical connections

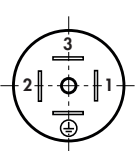
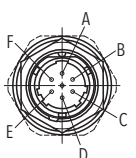
Ingress Protection	IP65 ²⁾ IP67 ¹⁾	IP68 max. 3m	IP67 ²⁾	IP67 ²⁾	IP65	IP67
Designation	EN175301-803A (DIN43650-A)	Cable* (PVC) (PUR) 4 x 0.25mm ²	M12x1 5-pol.	Packard Metri Pack 3-pol.	Industrial Standard contact distance 9.4 mm	MIL-C 26482
Type code	828X.XX.XXXX.05	828X.XX.XXXX.24/22/08	828X.XX.XXXX.35	828X.XX.XXXX.51	828X.XX.XXXX.01	828X.XX.XXXX.02
Pin configuration						

Output

4 ... 20 mA
 0 ... 5 VDC
 1 ... 6 VDC
 0 ... 10 VDC
 0.5 ... 4.5 VDC ratiom.

Load resistance

(U_{SUPPLY} - 9V) / 20mA
 > 2.5 kΩ
 > 5.0 kΩ
 > 5.0 kΩ
 ≥ 5.0 kΩ

I_{SUPPLY}

< 10 mA
 < 10 mA
 < 10 mA
 ≤ 10 mA

U_{SUPPLY}

9 ... 32 VDC
 9 ... 32 VDC
 9 ... 32 VDC
 15 ... 32 VDC
 5 (4.75 ... 5.25) VDC

¹⁾ With Trafag IP67 connector only

²⁾ Provided female connector is mounted according to instructions

* Ventilation via connector. Shield in the device is not connected

Electrical connections

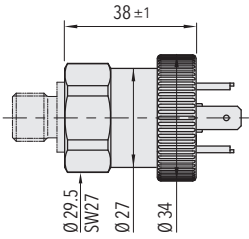

828X.XX.XXXX.05.XX.XX

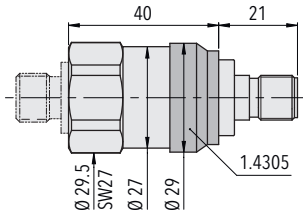

828X.XX.XXXX.35.XX.XX

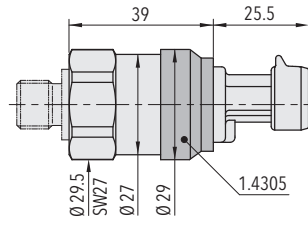

828X.XX.XXXX.51.XX.XX

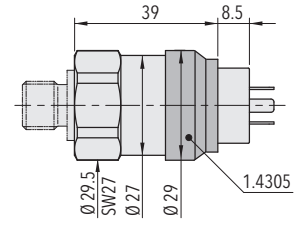

828X.XX.XXXX.01.XX.XX

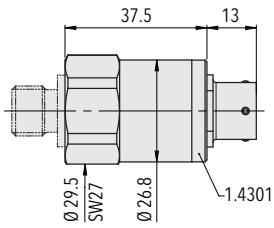

828X.XX.XXXX.02.XX.XX

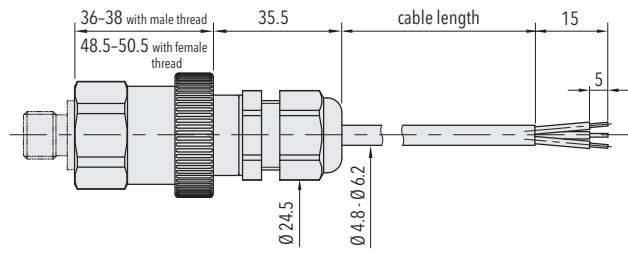

828X.XX.XXXX.24/22/08.XX.XX

Pressure connections

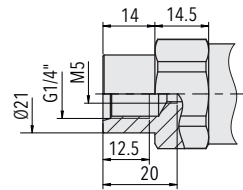

828X.XX.XX10.XX...

Pressure connections

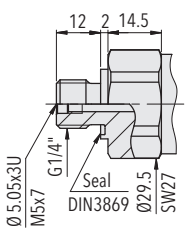

828X.XX.XX17.XX...

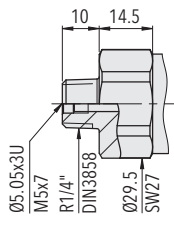

828X.XX.XX19.XX...

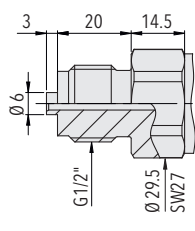

828X.XX.XX11.XX...

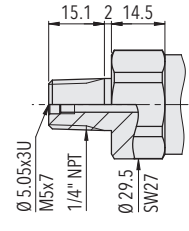

828X.XX.XX30.XX...

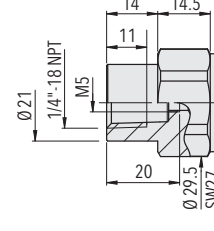

828X.XX.XX13.XX...

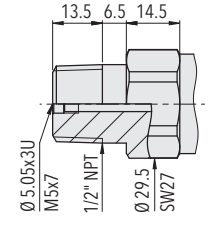

828X.XX.XX51.XX...

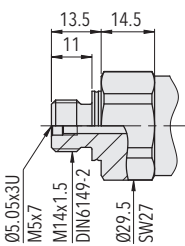

828X.XX.XX31.XX...

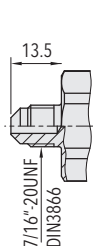

828X.XX.XX18.XX...

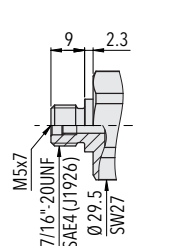

828X.XX.XX42.XX...

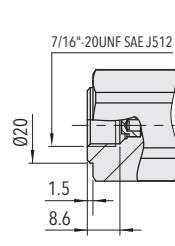

828X.XX.XX24.XX...

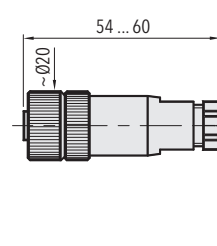

828X.XX.XXXX.XX.XX.33

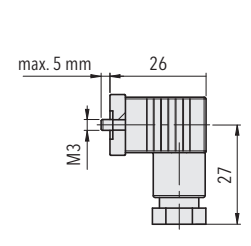

828X.XX.XXXX.XX.XX.34

Connection of the measuring equipment

Current output 2-wires

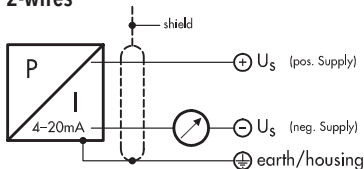

Voltage output 3-wires

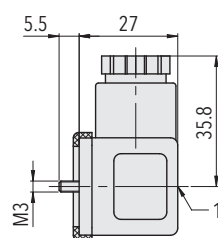
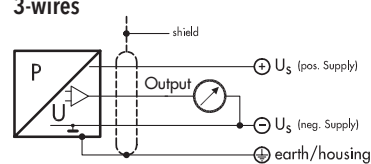

1) Tightening torque 50...60 Ncm

828X.XX.XXXX.XX.XX.56

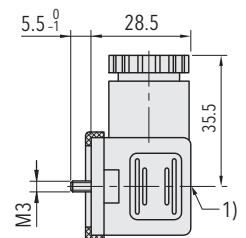

1) Tightening torque 50...60 Ncm

828X.XX.XXXX.XX.XX.58