

PRESSURE TRANSMITTER

Swiss based Trafag is a leading international supplier of high quality sensors and monitoring instruments for measurement of pressure and temperature.

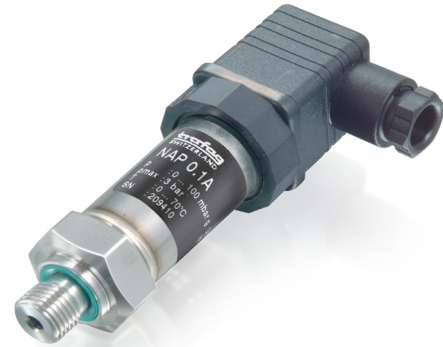

Applications

- Shipbuilding
- Machine tools
- Hydraulics
- HVAC
- Process technology
- Water treatment
- Food Industry

Features

- Low pressure ranges (to 100 mbar)
- Media temperature to 150°C
- EMC protection, IEC 61000
- Option: Lightning protection (IEC 61000-4-5), 10kA (8/20 μs)

Technical Data

Measuring principle	Piezoresistive	Media temperature	0°C ... +80°C (opt. -25 ... +100°C/-25 ... +150°C)
Measuring range	0 ... 0.1 to 0 ... 1000 bar	Ambient temperature	0°C ... +70°C (opt. -25 ... +85°C)
Output signal	4 ... 20 mA 0 ... 10 VDC	Approval / conformity	GL, KRS

02/2017

Data sheet H722.30h

Subject to change

Ordering information/type code

		XXXX	XX	XX	XX	XX	XX	XX	
Custom build code	Relative pressure	8842							
	Absolute pressure	8843							
Measuring range ¹⁾	Pressure measurement range [bar]	Over-pressure [bar]	Burst pressure [bar]		Pressure measurement range [bar]	Over-pressure [bar]	Burst pressure [bar]		
	0 ... 0.1	3	200	66	0 ... 16	48	200	79	
	0 ... 0.16	3	200	67	0 ... 25	75	200	80	
	0 ... 0.2	3	200	68	0 ... 40	120	850	81	
	0 ... 0.4	3	200	69	0 ... 60	180	850	82	
	0 ... 0.6	3	200	70	0 ... 100	300	850	83	
	0 ... 1.0	3	200	71	0 ... 160	480	850	85	
	0 ... 1.6	4.8	200	73	0 ... 250	750	850	74	
	0 ... 2.5	7.5	200	75	0 ... 400	850	850	84	
	0 ... 4	12	200	76	0 ... 600	850	850	86	
	0 ... 6	18	200	77	0 ... 1000	1500	1500	88	
	0 ... 10	30	200	78					
	Sensor	Type 05 (Accuracy NLH: $\pm 0.5\%$ FS) ²⁾							P5
		Type 02 (Accuracy NLH: $\pm 0.25\%$ FS) ²⁾							P2
Type 01 (Accuracy NLH: $\pm 0.1\%$ FS) ²⁾								P1	
Pressure connection	G1/4" female							10	
	G1/4" male							15	
	G1/4" male (Manometer)							20	
	G1/2" male							21	
	G1/2" male, frontal membrane							31	
	G1/2" male, flush membrane							32	
	G1/2" male (Manometer)							11	
Electrical connection	Cable PUR: Length ... (mm) IP67							22	
	Male electrical plug: DIN43650-A, Mat.: PA, IP65							04	
	Male electrical plug: Binder 723, 5-pole (Mat.: Zn), IP67							14	
	Male electrical plug: MIL-C 26482 (Mat.: Al), IP 40							02	
Output	4 ... 20 mA							19	
	4 ... 20 mA with lightning protection (Surge)							09	
	0 ... 10 VDC							17	
Accessories	Female electrical connector DIN43650 A							58	
	Female electrical connector: Binder 723							37	
	Female electrical connector: MIL-C 26482, 6-pole							32	
	Special oil filling: Aseol							94	
	Special oil filling: Halocarbon							95	
	8842: Electronics packed in gel							96	
	Cable PUR: IP67							48	
	Operating temperature -25 ... +85°C (Media temperature -25 ... +100°C)							69	
	Operating temperature -25 ... +85°C (Media temperature -25 ... +150°C)							70	
	Damping elements and snubber see data sheet H72258								

¹⁾ Customized pressure ranges upon request

²⁾ Accuracy NLH see table



Identical construction with other specifications:
Data sheet No. H72227, H72232

Standard products (extra short lead time)

Product No.	Type Code	Pressure range [bar]	Over pressure max. [bar]	Supply [VDC]	Accuracy @ 25°C typ. [%]
NAP0.1A	8842 66 P515 04 0000 0000 19 58	0 ... 0.1	3	9 ... 33	±0.5
NAP0.2A	8842 68 P515 04 0000 0000 19 58	0 ... 0.2	3	9 ... 33	±0.5
NAP0.4A	8842 69 P515 04 0000 0000 19 58	0 ... 0.4	3	9 ... 33	±0.5
NAP0.6A	8842 70 P515 04 0000 0000 19 58	0 ... 0.6	3	9 ... 33	±0.5
NAP1.0A	8842 71 P515 04 0000 0000 19 58	0 ... 1.0	3	9 ... 33	±0.5

Specifications		
Electrical Data	Output / supply voltage	4 ... 20 mA: 9 ... 33 VDC 0 ... 10 VDC: 15 ... 30 VDC
	Load	4 ... 20 mA: $R_L \leq (U_s - 9V)/20 \text{ mA}$ 0 ... 10 VDC: $R_L > 10 \text{ k}\Omega$
	Rise time	typ. 1 ms/10...90 % nominal pressure
Environmental conditions	Media temperature	0°C ... +80°C (opt. -25 ... +100°C/-25 ... +150°C)
	Ambient temperature	0°C ... +70°C (opt. -25 ... +85°C)
	Protection ¹⁾	Min. IP65
	Humidity	Max. 95% relative
	Vibration	6g (25...2000 Hz)
	Shock	50g/ 1 ms
EMC Protection	Emission	EN/IEC 61000-6-3
	Immunity	EN/IEC 61000-6-2
Mechanical Data	Sensor (wetted parts)	1.4435 (AISI316L)
	Pressure connection (wetted parts)	1.4435 (AISI316L)
	Housing	1.4435 (AISI316L)
	Sealing	FKM 70 Sh
	Male electrical plug	See ordering information
	Weight	~ 220 g
	Mounting torque	25 Nm

¹⁾ Provided female connector is mounted according to instructions

Accuracy						
Pressure measuring range	[bar]	0.1 ... 0.5	0.5 ... 2	2 ... 25	25 ... 600	> 600
Accuracy NLH (BSL through 0) P5	[% FS]	± 0.5	± 0.5	± 0.5	± 0.5	± 0.5
Accuracy NLH (BSL through 0) P2	[% FS]	± 0.25	± 0.25	± 0.25	± 0.25	± 0.25
Accuracy NLH (BSL through 0) P1	[% FS]	-	± 0.1	± 0.1	± 0.1	-
Temperature coefficient zero point 0 ... +70°C	[% FS/K]	± 0.06	± 0.03	± 0.015	± 0.015	± 0.015
Temperature coefficient zero point Option -25 ... +85°C	[% FS/K]	± 0.08	± 0.04	± 0.02	± 0.02	± 0.02
Temperature coefficient span Option -25 ... +85°C	[% FS/K]	± 0.015	± 0.015	± 0.015	± 0.015	± 0.015
Temperature coefficient span Option -25 ... +85°C	[% FS/K]	± 0.02	± 0.02	± 0.02	± 0.02	± 0.02
Long term drift	[1 year]	< 4 mbar	< 4 mbar	< 0.2 % FS	< 0.2 % FS	< 0.2 % FS
Repeatability	[% FS]	± 0.05	± 0.05	± 0.05	± 0.05	± 0.05

Dimensions

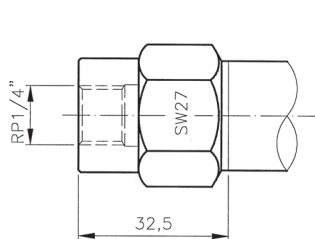

884X.XX.XX.10.XX.XX.XX

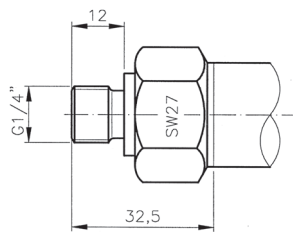

884X.XX.XX.15.XX.XX.XX

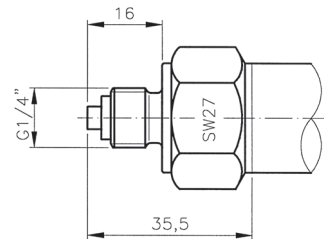

884X.XX.XX.20.XX.XX.XX

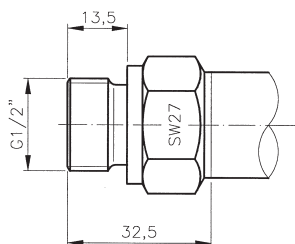

884X.XX.XX.21.XX.XX.XX

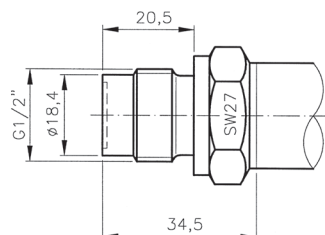

884X.XX.XX.31.XX.XX.XX

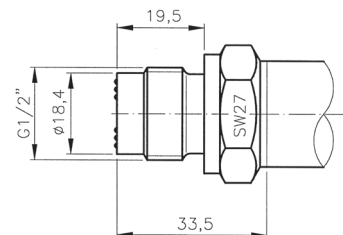

884X.XX.XX.32.XX.XX.XX

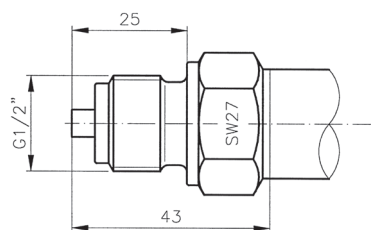

884X.XX.XX.11.XX.XX.XX

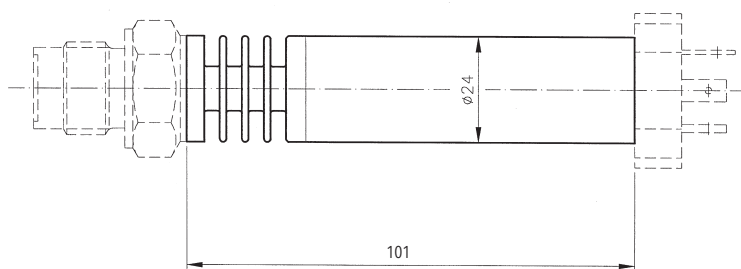

884X.XX.XX.XX.XX.XX.70

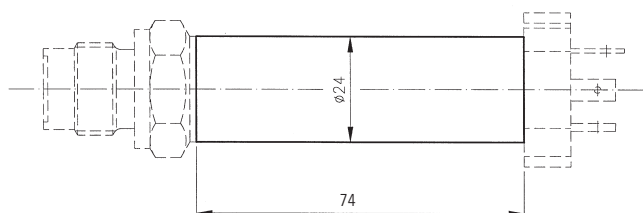

884X.XX.XX.XX.XX.XX.XX

884X.XX.XX.XX.XX.XX.69

Dimensions

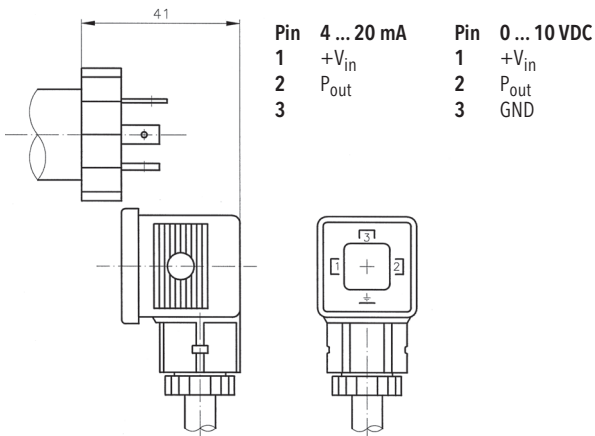

884X.XX.XX.XX.04.XX.58

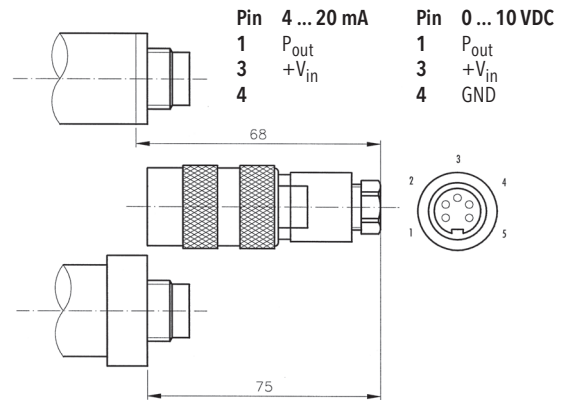

884X.XX.XX.XX.14.XX.37

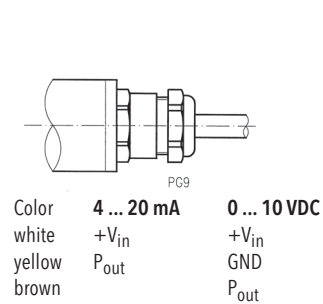

884X.XX.XX.XX.22.XX.XX

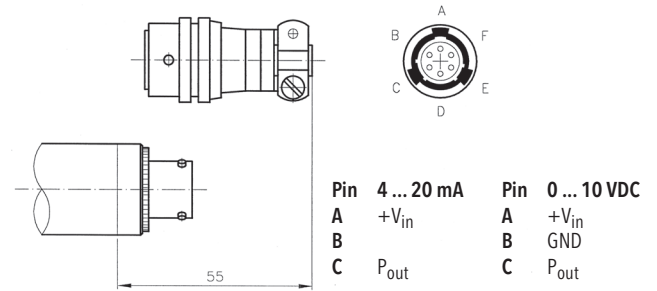

884X.XX.XX.XX.02.XX.32

Electrical connection

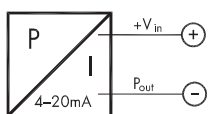

4 ... 20 mA

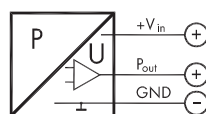

0 ... 10 VDC

Additional information

Documents

Data sheet	www.trafag.com/H72230
Instructions	www.trafag.com/H73208
Flyer	www.trafag.com/H70683

Additional specifications		
Electrical Data	Resistance of insulation	>10 MΩ, 250 VDC
	Dielectric strength	500 VAC, 50 Hz
	Current limiting output signal	4 ... 20 mA: appr. 31 mA (Overload)
Environmental conditions	Storage temperature	0°C ... +70°C
EMC Protection	ESD	EN/IEC 61000-4-2, Level 3
	RFI	EN/IEC 61000-4-3, Level 3
	Burst	EN/IEC 61000-4-4, Level 3
	Surge	EN/IEC 61000-4-5, Level 3 R _i = 42Ω
	Conducted Immunity	EN/IEC 61000-4-6, Level 3